

Add Device

Home page

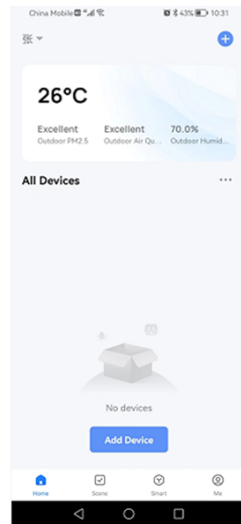

1. On the APP Home page, the local temperature and humidity will be displayed at the top after location positioning.

(All devices added can be displayed after adding devices)

Add Device page

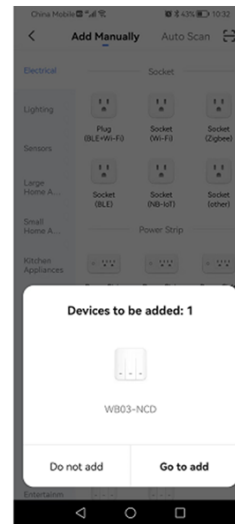

2. Press and hold the first button of the 3-button switch of the device for 8 seconds, the blue light flashes, and then enter the WIFI pairing mode.

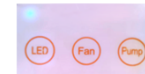

After the device enters the WIFI pairing mode, click Add Device on the home page to find the device that can be added.

Add Device page

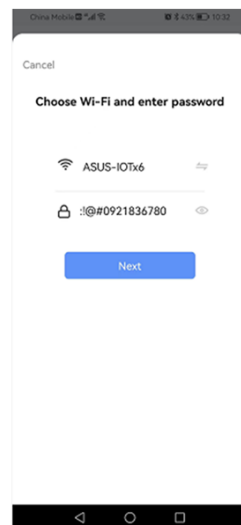

3. Enter the router's account and password for network configuration.

Home page

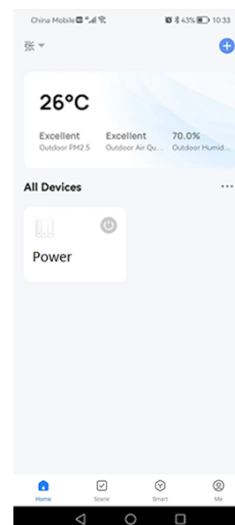

4. After the addition is complete, the added devices can be displayed on the home page.

Device naming

Home page

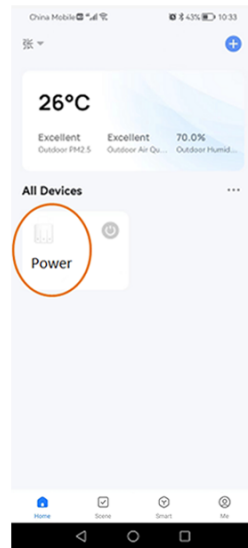

Home page → Device page

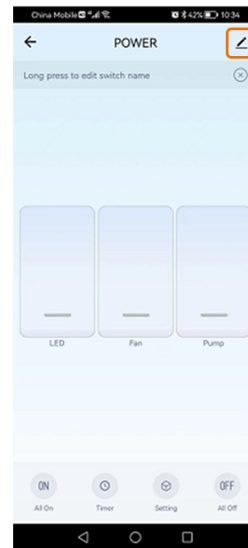

Home page → Device page → edit → name

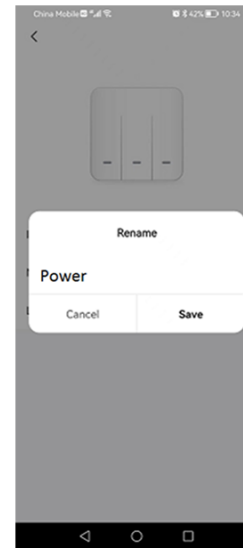

5. Users can modify the name of the device by themselves, which is convenient to distinguish each device when there are multiple devices.

Home page

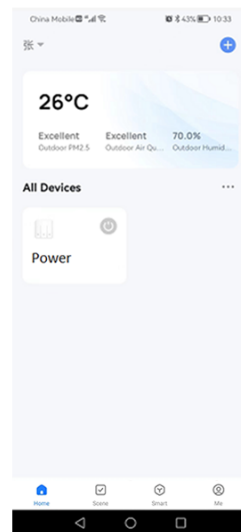

6. Users can modify the name of the device by themselves, which is convenient to distinguish each device when there are multiple devices.

Switch naming

Device page

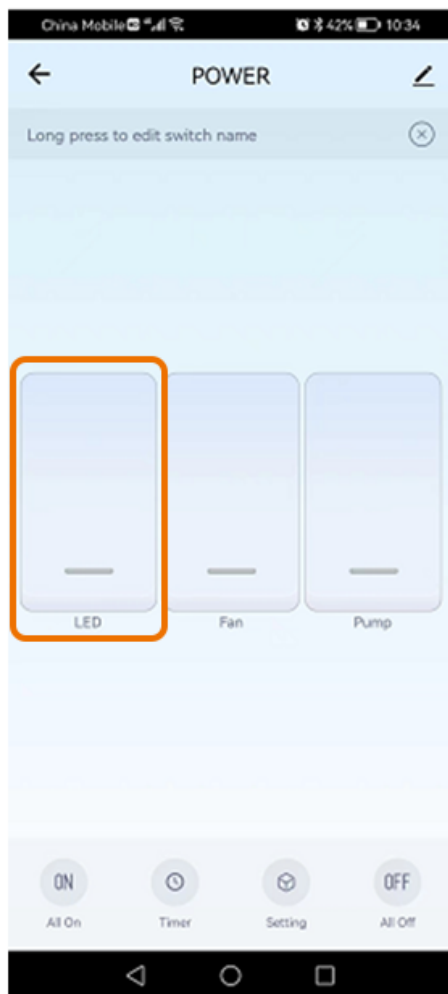

7. Click the device on the main page to enter the device operation interface. This device is a three-way switch, which can control three device switches respectively.

There are full on, full off, timing and setting functions below.

Device page



8. Long press the switch to modify the switch name.

Decice switch timing - Schedule

Device page



Device page → Timer

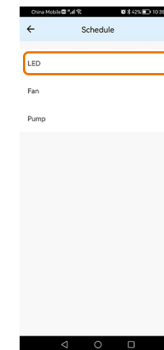

9. Timing function, you can set the timing function for the three-way switch respectively to control the switching time

Device page → Timer → Power → Schedule

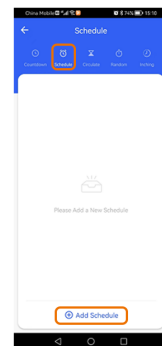

11. Timing functions include countdown, time timing, cycle timing, random timing and jog switch.

There are mainly two kinds of time timing and cycle timing.

Device page → Timer → Power → Schedule → Add Schedule

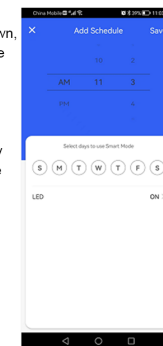

12. Time timing, the user can set which days of the week, what time and what time, the device will be turned on or off.

Device page → Timer → Power → Circulate

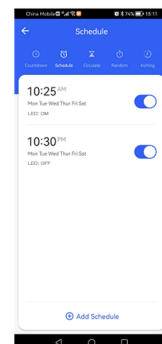

13. The time set as shown in the picture is from Monday to Saturday every week, the device LED is turned on at 10:25 in the morning, and the device is turned off at 10:30 in the evening.

Decice switch timing - Circulate

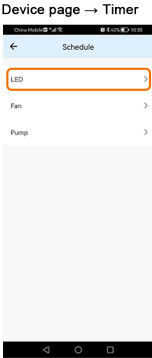

9. Timing function, you can set the timing function for the three-way switch respectively to control the switching time

Device page → Timer → Power → Circulate



14. Cycle timing, you can set which days of the week, what ime to what time every day, how long to open, and how long to close.

Device page → Timer → Power → Circulate → Add Circulate

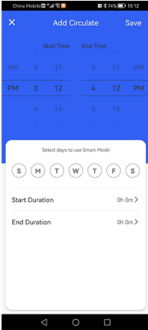

14. Cycle timing, you can set which days of the week, what ime to what time every day, how long to open, and how long to close.

Device page → Timer → Power → Circulate

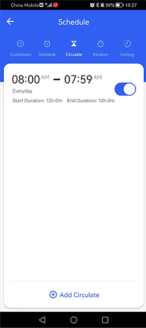

15. As shown in the figure, it is set every day of a week, from 8:00 in the morning to 07:59 in the evening, the LED turns on for 12 hours and turns off for 12 hours.

Restart status

Device page

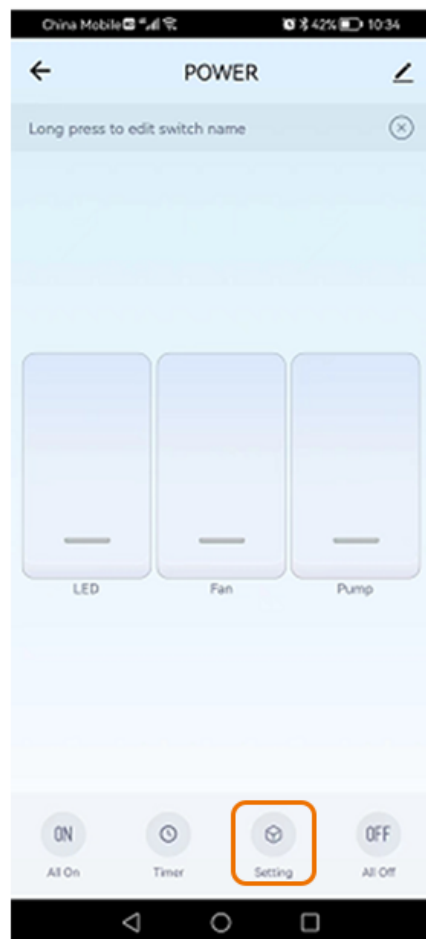

Device page → Setting

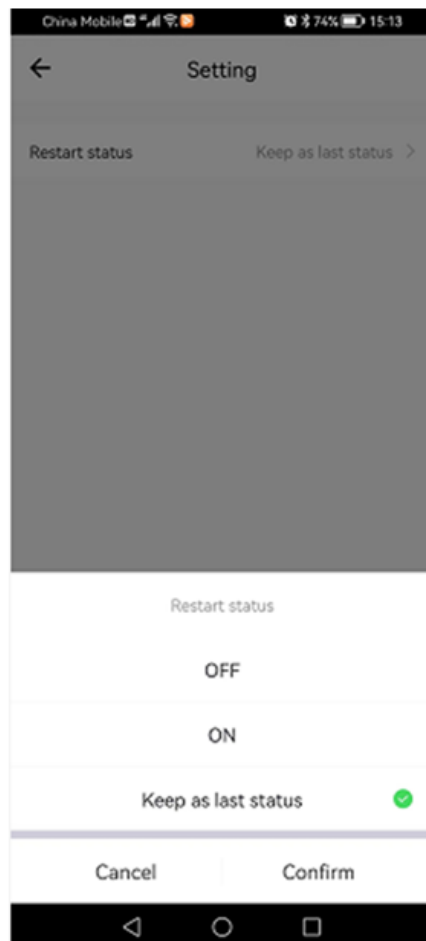

16. Setting function.

Set whether the device is in the on state, the off state, or the state before the power off after the device is powered off and restarted.

Temperature and humidity sensor pairing

The following are optional:

Temperature and Humidity Sensor and IP Camera



IP Camera



Temperature and Humidity Sensor

Temperature and Humidity Sensor



17. First use the card pin to press the Reset button, when you hear a BI sound and a WIFI signal appears on the temperature and humidity sensor, enter the pairing mode at this time.

Greenhouse temperature sensor

Home page

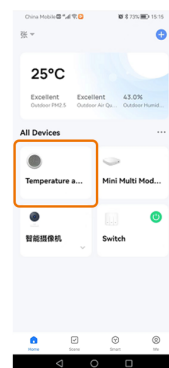

18. Add the greenhouse temperature sensor to the device.

Home page →

Temperature and humidity sensor



19. Click on the temperature and humidity sensor to enter the device to view the temperature and humidity values.

Smart Scene

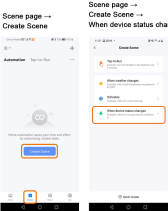

20. Create a smart scene, you can set the trigger device after reaching a certain condition, and carry out the device linkage.

Such as linkage temperature and humidity sensor and 3-button switch.

When the state of the device changes.

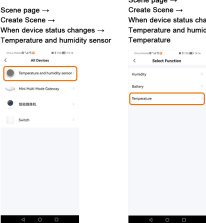

21. Click on the temperature and humidity sensor, temperature.

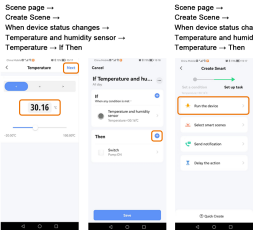

22. When the set temperature is greater than 30, select the operating device.

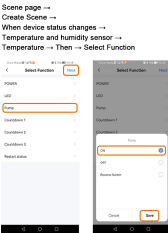

23. Select the device. Select Motor, then set ON.

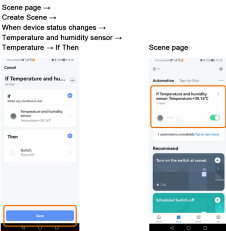

24. After the configuration is complete, click Save to save it successfully.

After the addition is successful, the motor can be turned on when the temperature and humidity sensor detects that the temperature is greater than 30 degrees.

Language

Chinese Version

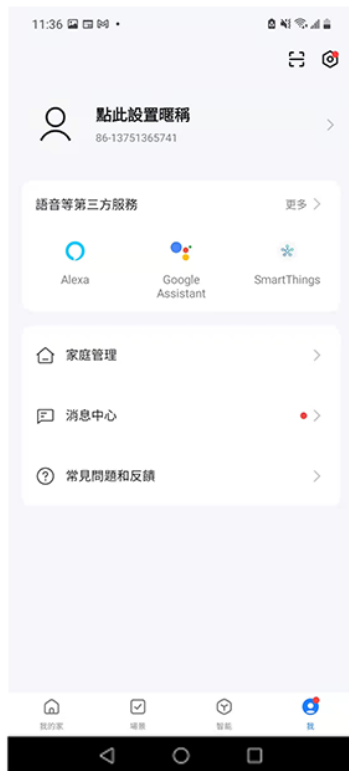

English version

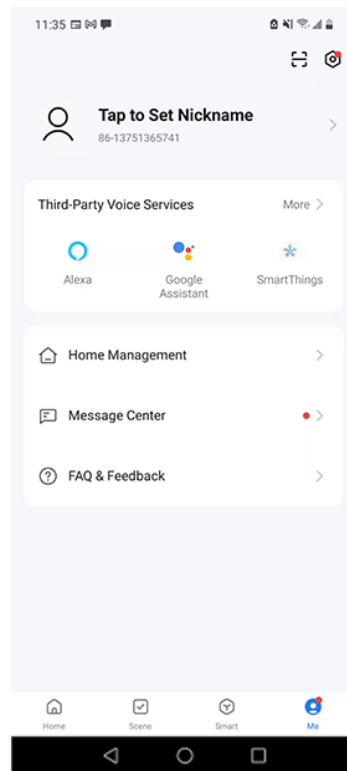

Voice and other third-party services, the APP is divided into Chinese and English versions corresponding to different voice services.